

Shower - LULU

Concealed thermostat with two-way volume control - polished chrome

Article number: 36 426 710-00 0010

- Diverter with integrated volume control and integrated stops
- Cover plate 5-7/8" x 3-1/2"
- Temperature control handle with safety lock at 100 °F/ 38°C
- Max. temperature can be set on the trim
- (ADA)

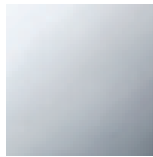

polished chrome

Accessory is required for this item.

Dimensional drawing

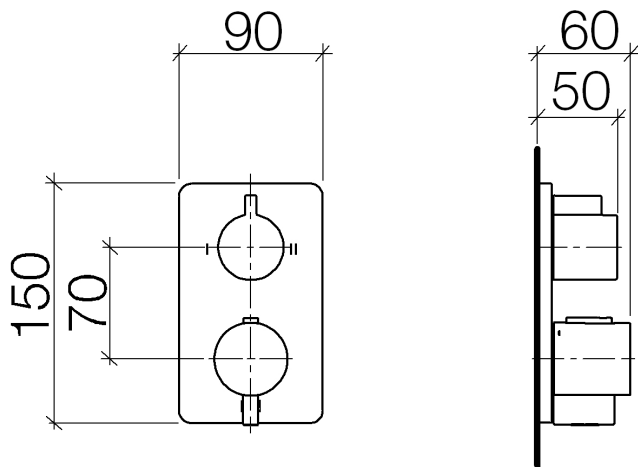

All dimensions in mm / inch = mm x 0,0394



Shower - LULU

Concealed thermostat with two-way volume control - polished chrome

Article number: 36 426 710-00 0010

Flow rate chart

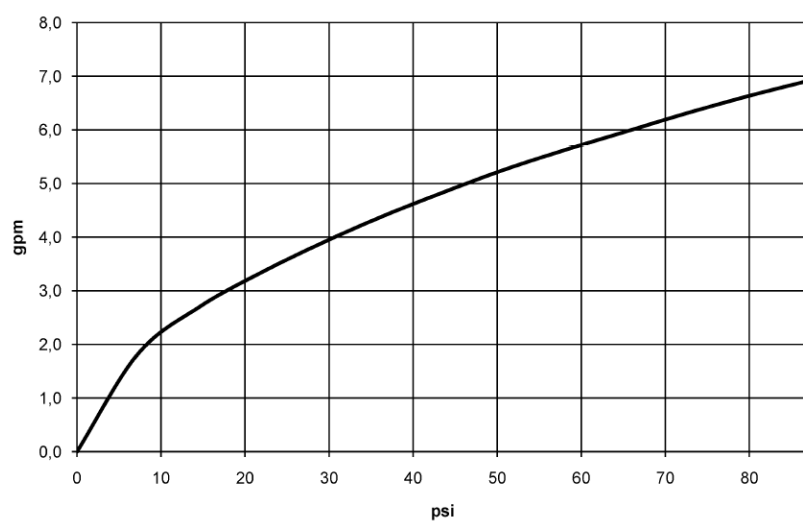



Shower - LULU
Concealed thermostat with two-way volume control - polished chrome
Article number: 36 426 710-00 0010

Other surface finishes



platinum matte
36 426 710-06 0010

More custom finish options are available via special production (xTra Service). Please see our finish matrix for availability and pricing or contact a Dornbracht representative.

Required article



35 426 970-90 0010
Concealed thermostat with
integrated supply stops -

Spare parts list

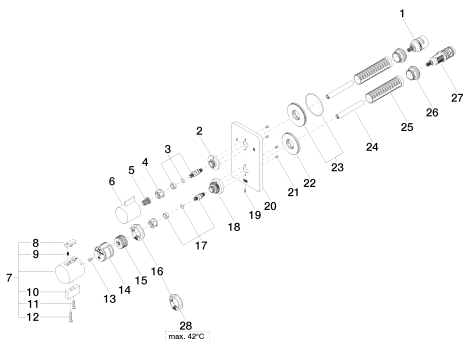

Number	Item Number	Designation	Number of units
--------	-------------	-------------	-----------------